

Register No.:

576

April 2023

Time - Three hours
(Maximum Marks: 100)

- N.B.**
1. Answer all questions under Part-A each question carries 3 marks.
 2. Answer all the questions either (A) or (B) in Part-B each question carries 14 marks.

PART - A

1. Write about detailed estimate.
2. What are the types of approximate estimates?
3. Write about observed data.
4. Prepare the data for Cement mortar 1:5-1m³, Cement -Rs.5500/1MT, Sand - Rs.460/m³.
5. What is meant by taking off quantities?
6. State any five items of work in a building to be constructed in sequence.
7. Define billing.
8. What are the advantages of group system?
9. State the purpose of valuation.
10. Define standard rent.

PART - B

11. (a) Explain the steps involved in writing standard specification.

(Or)

- (b) Define Estimate and explain the types of estimate.

[Turn over.....

12. (a) Prepare the data for brick work in super structure using first class brick for the following details:

Materials and labour required:

BW with CM 1:5	- 10m ³
Bricks	- 5000 Nos.
CM 1.5	- 1.4m ³
Mason I class	- 7.0 Nos.
Mason II class	- 7.7 Nos
Mazdoor I class	- 8.1 Nos.
Mazdoor II class	- 8.4 Nos.

Cost of materials and labours (in Rupees):

Bricks	- 5200/1000 Nos
Cement	- 9000/ton
Sand	- 7500/m ³
Mason I class	- Rs. 550 each/day
Mason II class	- Rs.475 each/day
Mazdoor I class	- Rs.375 each/day
Mazdoor II class	- Rs. 300 each/day
Mixing charges	- Rs.150/m ³

(Or)

- (b) Prepare the data for Plastering the brick masonry for the following details:

Quantity of materials and labour required:

Plastering the brick masonry in CM 1:5 12mm thick - 10m²

Cement mortar 1:5	- 0.14 m ³
Mason Ist class	- 1.10 nos
Mazdoor Ist class	- 0.50 nos
Mazdoor IInd class	- 1.10 nos

Cost of materials and labour :

Cement	- Rs. 5200/ ton
Sand	- Rs. 500/ m ³
Mixing charges	- Rs. 100/ m ³
Mason Ist class	- Rs. 450 each per day
Mason IInd class	- Rs. 350 each per day
Mazdoor Ist class	- Rs. 300 each per day
Mazdoor IInd class	- Rs. 100 each per day

13. (a) (i) Write short notes on center line method. (7)
 (ii) List out duties of a good quantity surveyor. (7)

(Or)

- (b) Taking off quantities using Trade system for RCC 1:2:4 mix for Community hall with RCC columns and T-beams given in the Sketch-A.

SKETCH A

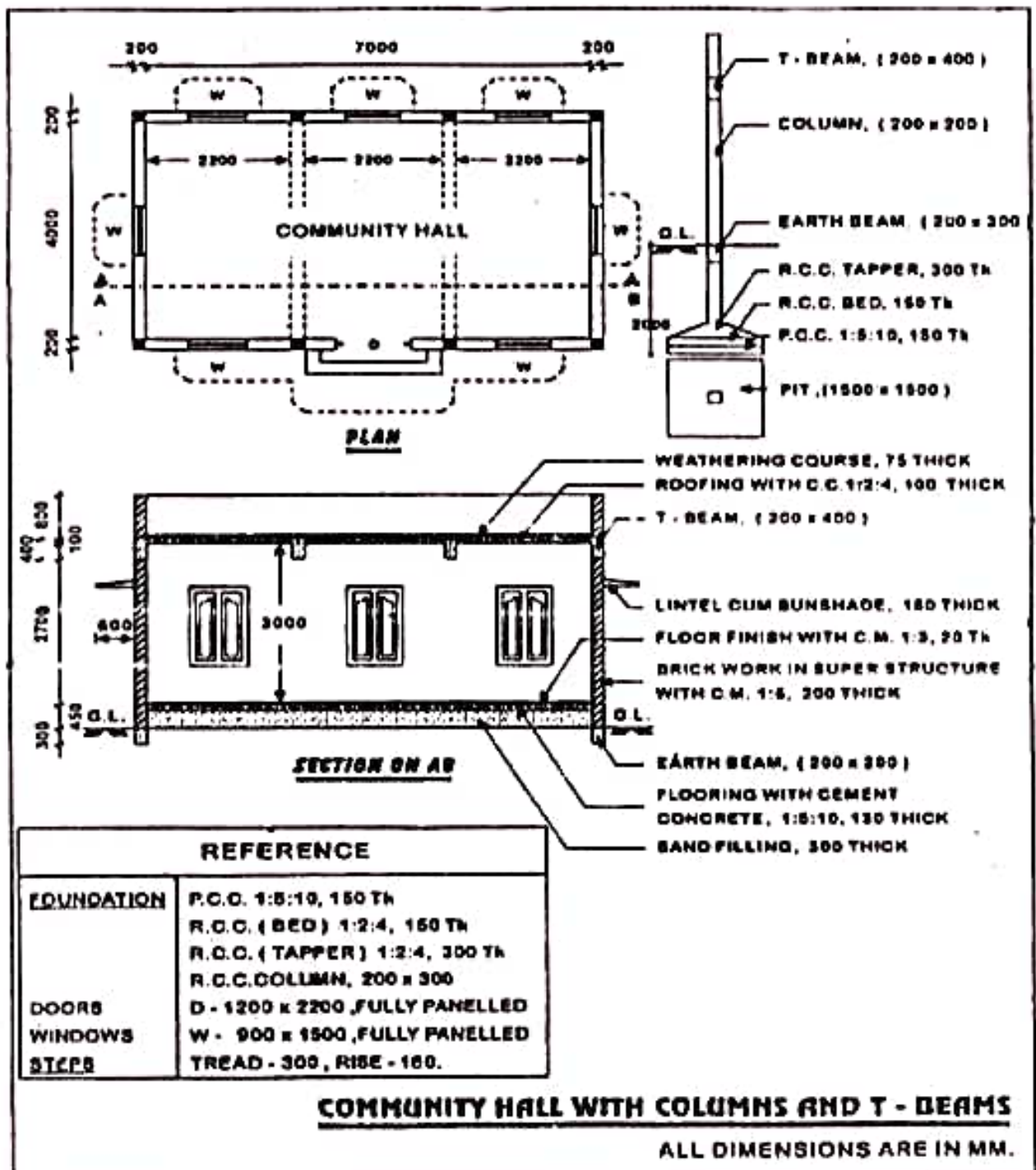

14. (a) Prepare the detailed estimate of quantities for Floor finish with C.M 1:3, 20mm thick for a ONE ROOMED BUILDING given in sketch -B by Group system.

Sketch B

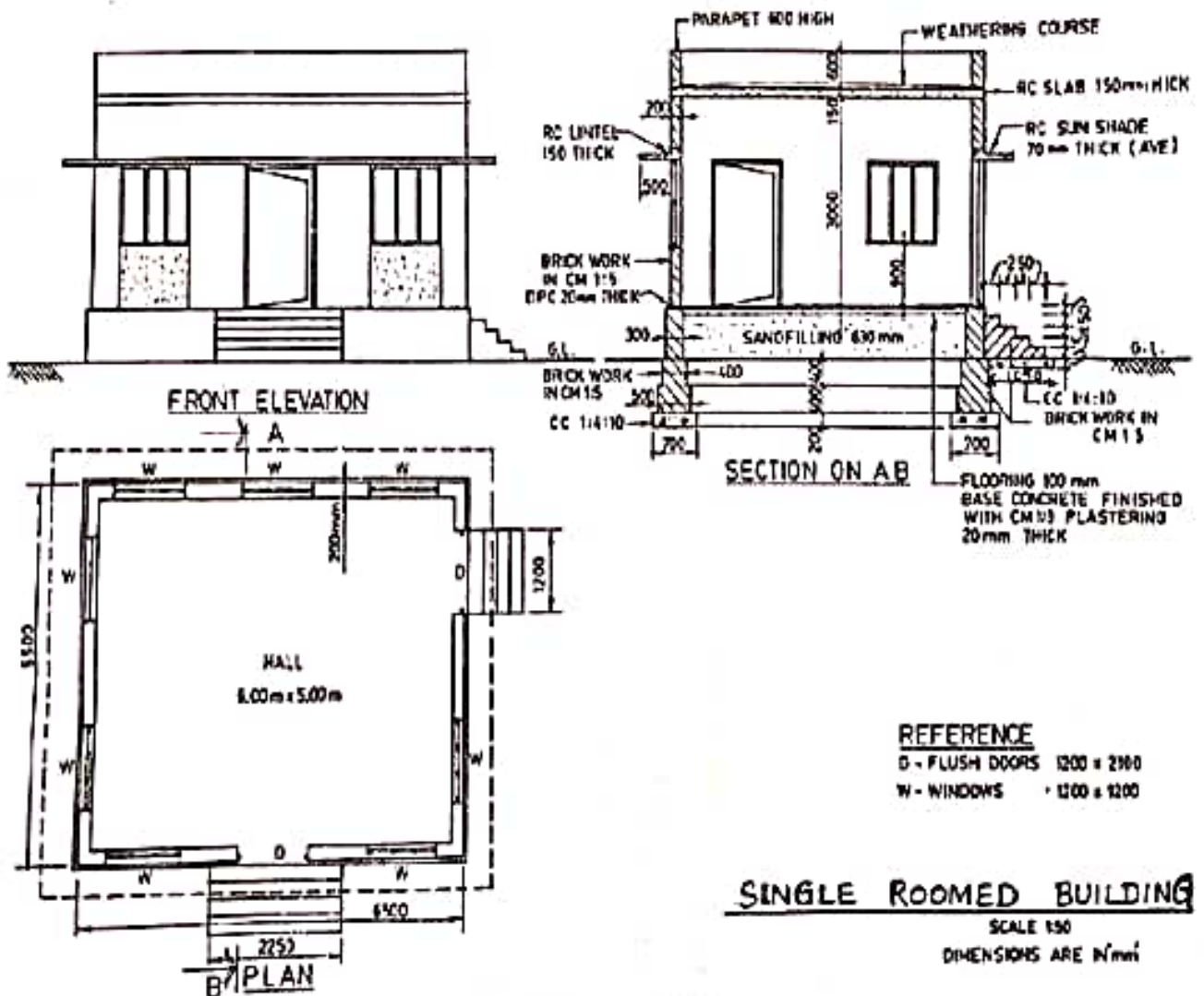

(Or)

- (b) Prepare the detailed estimate of quantities for DPC with C.M 1:3 20mm thick for a small residential building with three rooms (BHK) with R.C.C roof given in sketch -C by Group system.

Sketch C

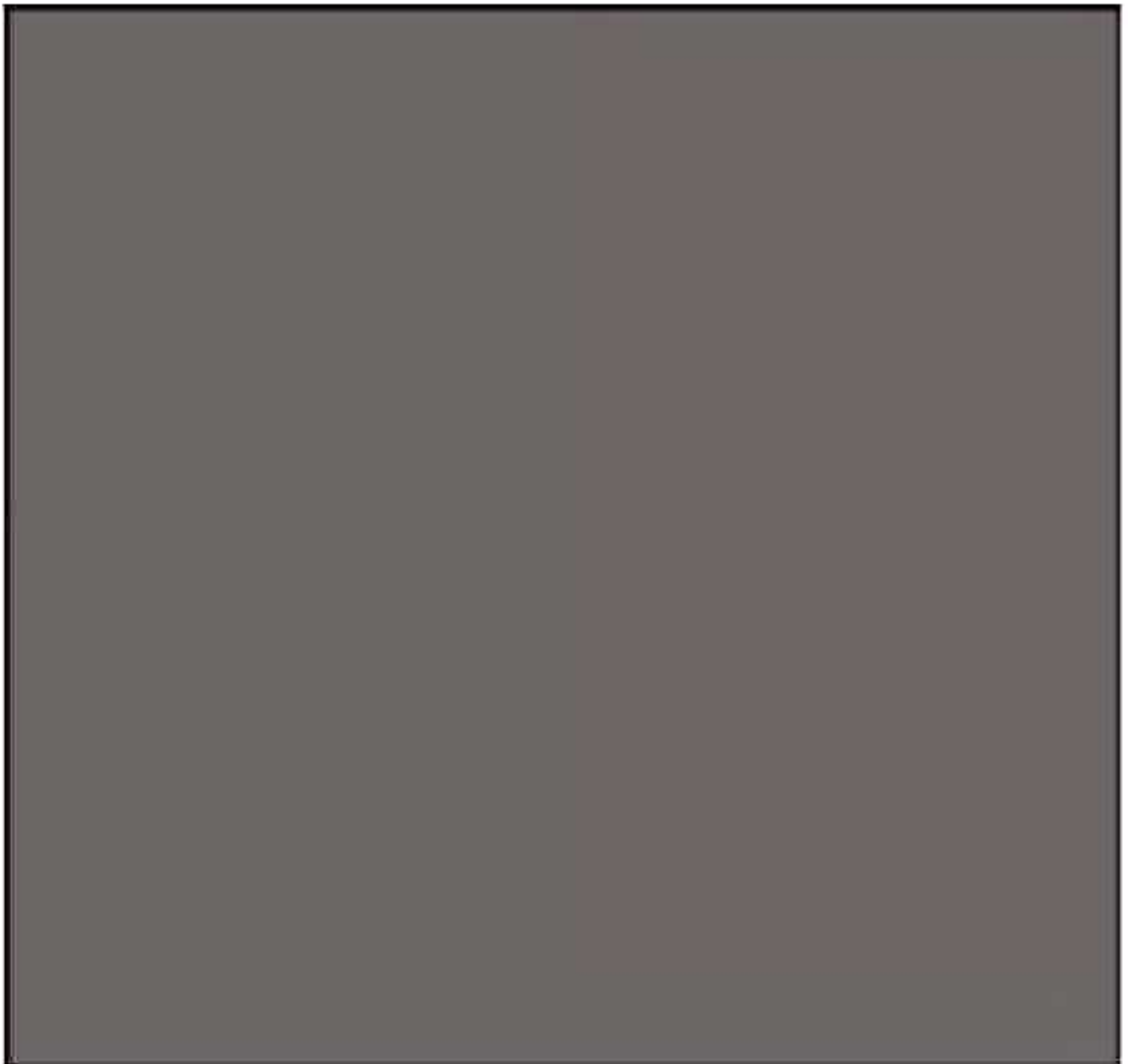

15. (a) State the various points to be considered while writing technical reports.

(Or)

- (b) Explain about sinking fund method.
